

**RAILWAY (LUAS FINGLAS - BROOMBRIDGE TO CHARLESTOWN) ORDER [2024]  
("RAILWAY ORDER")**

**THIS DOCUMENT MUST BE READ IN CONJUNCTION WITH THE RAILWAY ORDER**

The following amendments were made to the Railway Order by Court Orders dated 13 April 2026:

1. Those parts of (i) Plot D1-331-T6, (ii) Plot D1-331-A3 and (iii) Plot D1-331-T4 depicted on the drawing included in Schedule 1 hereto (comprising an area of (i) 72.9m<sup>2</sup> from Plot D1-331-T6, (ii) 98.4m<sup>2</sup> from Plot D1-331-A3 and (iii) 31.0m<sup>2</sup> from Plot D1-331-T4) (the "**Lands to be removed**") have been removed from the Railway Order;
2. All works associated with the Lands to be removed have been excised from the Railway Order; and,
3. Plot D1-331-A2 and the remaining part of Plot D1-331-A3, being an area of 99.9m<sup>2</sup>, have been moved from the Second Schedule to the Railway Order (permanent acquisition) to the Fourth Schedule to the Railway Order (temporary acquisition) which said plots are depicted on the drawing included in Schedule 2 hereto.

**END**

## **SCHEDULE 1**

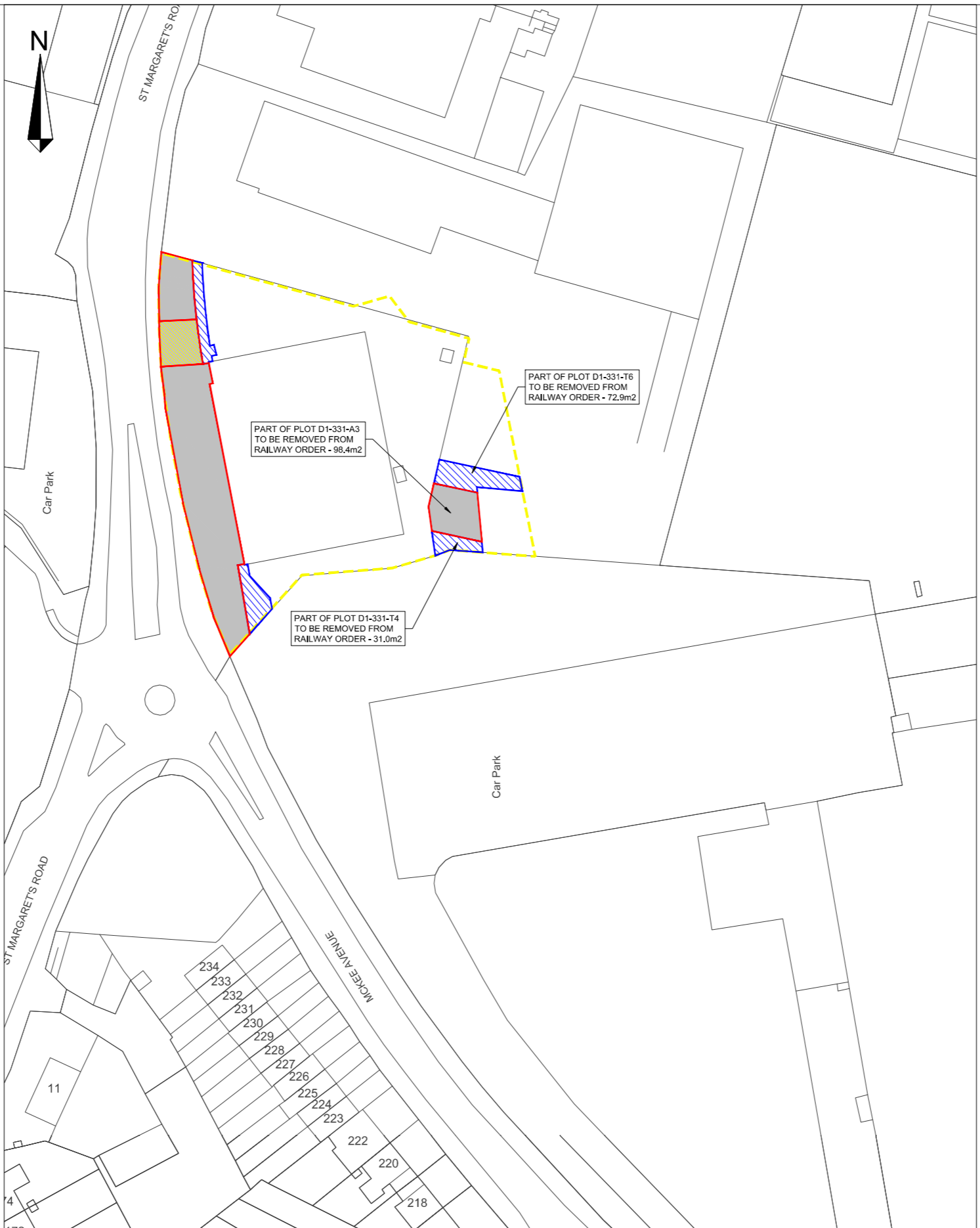

The information contained herein has been provided by TII but does not purport to be comprehensive or final. Recipients should not rely on the information. Neither TII nor any of its directors, officers, employees, agents, stakeholders or advisers make any representation or warranty as to, or accept any liability or responsibility in relation to, the adequacy, accuracy, reasonableness or completeness of the information provided as part of this document or any matter on which the information is based (including but not limited to loss or damage arising as a result of reliance by recipients on the information or any part of it). Any liabilities are hereby expressly disclaimed.

© National Roads Authority (NRA) 2026. This drawing is confidential and the copyright in it is owned by NRA. This drawing must not be either loaned, copied or otherwise reproduced in whole or in part or used for any purpose without the prior permission of NRA. Transport Infrastructure Ireland (TII) is an operational name of the National Roads Authority.  
 © Blausy International Ltd. © National Mapping Division of Talla Gireann: CYAL50512887. All elevations are in metres and relate to Geoid Model (OSGM02) Mean Head as defined by existing Project Control. All Co-ordinates are in Irish Transverse Mercator Grid (ITM) as defined by VRS active GNSS station Tallaght College (TLLG).

REV	DATE	DESCRIPTION	BY	CHK	APPD
P01.02	---	FOR INFO RO DELETION - 25.03.26	---	---	---

PROJECT: <b>LUAS</b> FINGLAS		CLIENT: <b>TII</b> Transport Infrastructure Ireland		AUTHORITY: <b>NTA</b> Údará Náisiúna Iompair National Transport Authority	
CONSULTANT: <b>BARRY</b> TRANSPORTATION <b>egis</b>					
DRAWN: ---	CONTENT CHECK: ---	QUALITY CHECK: ---	APPROVED: ---	DATE: ---	
SCALES: 1:500		DRAWING STATUS: Initial non-contractual code			

PROJECT TITLE: <b>LUAS FINGLAS - PRELIMINARY DESIGN &amp; STATUTORY PROCESS</b>	CHAINAGE / CORE AREA: 33		
PROCUREMENT REF: LDD101	BASE MODEL REF:		
DRAWING TITLE: <b>RAILWAY WORKS</b> LUAS FINGLAS - PROPERTY DETAILS JAMESTOWN BP ACCESS ROAD MURDOCK BUILDERS MERCHANTS			
FILE NAME: LDD101-BEV-PA-GZ33-XX-DR-TX-02001	SUITABILITY REVISION PLAN NUMBER: D1-P33 1-2		
<table border="1"> <tr> <td>S0</td> <td>P01.02</td> </tr> </table>		S0	P01.02
S0	P01.02		

## SCHEDULE 2

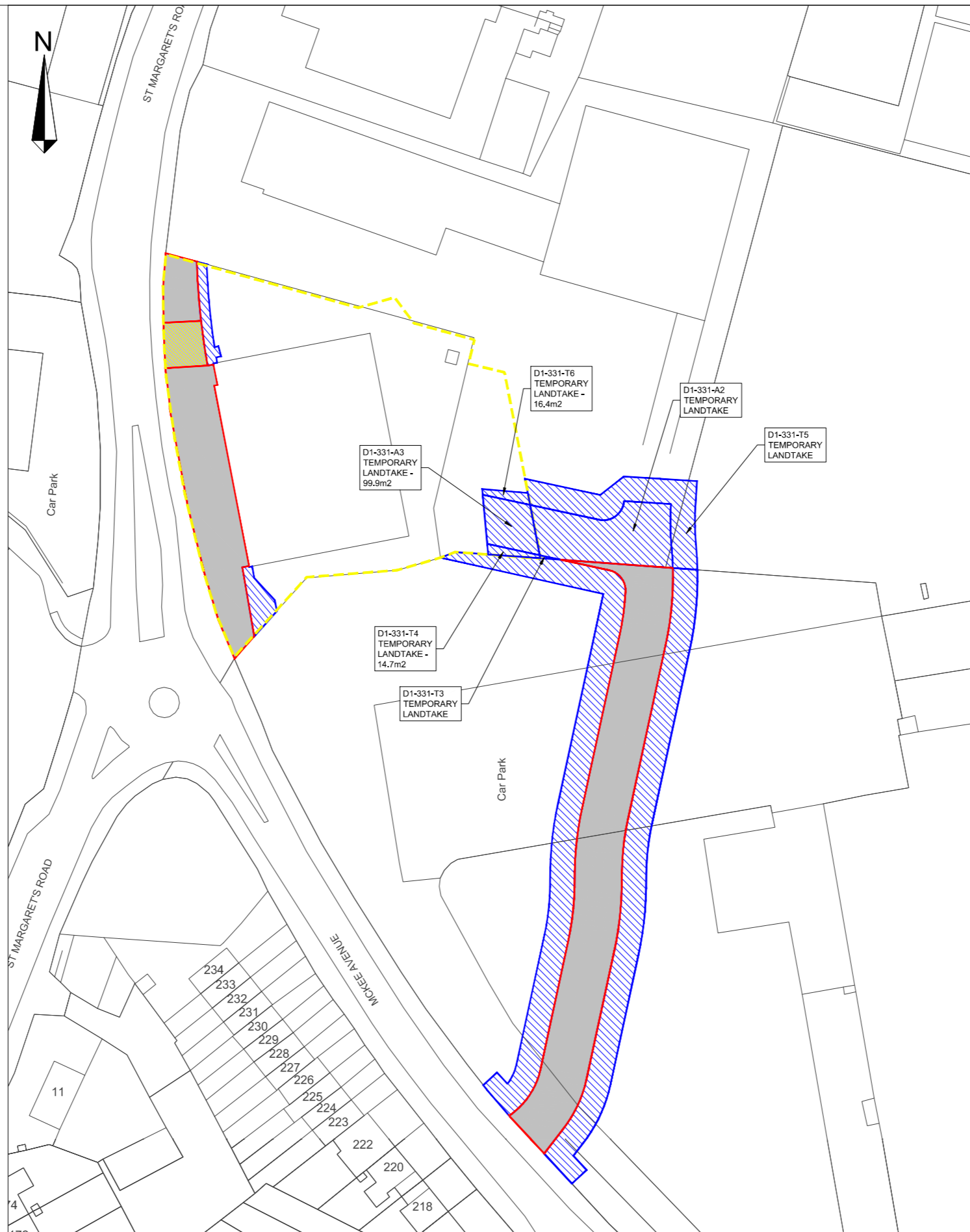

**TEMPORARY LANDTAKE**

The information contained herein has been provided by TIU but does not purport to be comprehensive or final. Recipients should not rely on the information. Neither TIU nor any of its directors, officers, employees, agents, stakeholders or advisers make any representation or warranty as to, or accept any liability or responsibility in relation to, the adequacy, accuracy, reasonableness or completeness of the information provided as part of this document or any matter on which the information is based (including but not limited to loss or damage arising as a result of reliance by recipients on the information or any part of it). Any liabilities are hereby expressly disclaimed.

© National Roads Authority (NRA) 2026. This drawing is confidential and the copyright in it is owned by NRA. This drawing must not be either loaned, copied or otherwise reproduced in whole or in part or used for any purpose without the prior permission of NRA, Transport Infrastructure Ireland (TII) is an operational name of the National Roads Authority.  
 © Bluesky International Ltd, © National Mapping Division of Taithe Eireann CYAL50512887. All elevations are in metres and relate to Geoid Model (OSGM02) Mean Head as defined by existing Project Control. All Co-ordinates are in Irish Transverse Mercator Grid (ITM) as defined by VRS active GNSS station Tallaght College (TLLG).

REV	DATE	DESCRIPTION	BY	CHK	APPD
P01.01	---	FOR INFO TEMPORARY LANDTAKE - 10.03.26	---	---	---

PROJECT: **LUAS FINGLAS**

CLIENT: **TIU** (Transport Infrastructure Ireland)

CONSULTANT: **BARRY TRANSPORTATION** and **egis**

DRAWN: --- CONTENT CHECK: --- QUALITY CHECK: --- APPROVED: --- DATE: ---

SCALES: 1:500 DRAWING STATUS: Initial non-contractual code

PROJECT TITLE: **LUAS FINGLAS - PRELIMINARY DESIGN & STATUTORY PROCESS**

PROCUREMENT REF: **LDD101**

DRAWING TITLE: **RAILWAY WORKS**  
 LUAS FINGLAS - PROPERTY DETAILS  
 JAMESTOWN BP ACCESS ROAD  
 MURDOCK BUILDERS MERCHANTS

CHAINAGE / CORE AREA: 33

BASE MODEL REF:

FILE NAME: **DRAWING 2**

PLAN NUMBER: **D1-P33 1-2**

SUITABILITY REVISION: **S0 P01.01**